

# fireflex

fire barriers for use with expansion joints that extend through fire compartment floors and walls

## Typical Components

- (1) Concrete slab
- (2) 2 hour or 4 hour fire rated fire barrier compressed into expansion gap
- (3) Expansion joint fitted directly over fire barrier and centred over the expansion gap
- (4) Waterproofing membrane

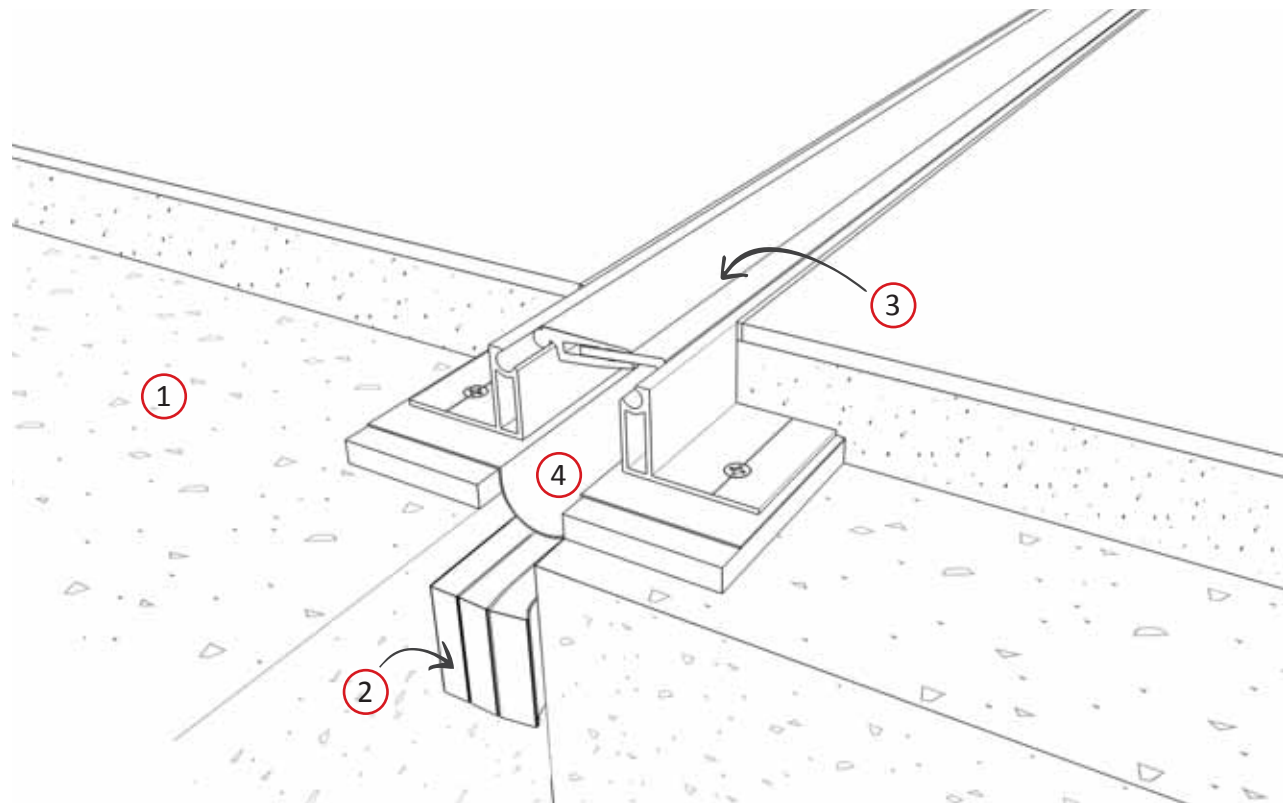

## FIRE BARRIER SYSTEM

Floor to Floor to Wall | Wall to Wall

25 - 125 mm ( 1 - 5" ) Expansion Gaps

# Fireflex 2000 : A01-A02

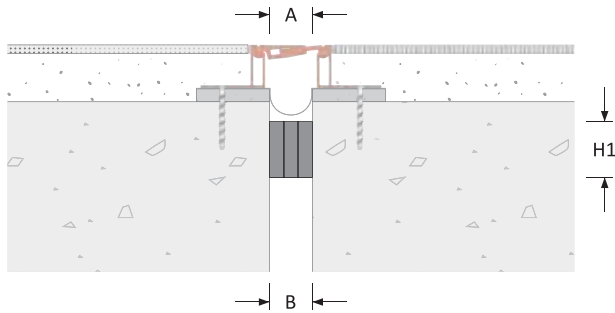

### Fire Barrier Selection Criteria

### Load Rating

### Product Details

Joint Location	Gap Width B(mm)	Movement Capacity (mm)		Eurocode Rating				Product Dimensions			Product Number		
		±	[Total]					Height		Sightline		Blockout	
								H1 (mm)	H2 (mm)	A (mm)	C (mm)		
2 Hour Fire Rated (120 mins)													
Floor - Floor	25	± 12	[25]					65	-	-	-	25	2000-A01-025-2
	35	± 17	[35]									35	2000-A01-035-2
Floor - Wall	50	± 25	[50]									50	2000-A01-050-2
Wall - Wall	75	± 37	[75]	-	-	-	-					75	2000-A01-075-2
Corner Wall	100	± 50	[100]									100	2000-A01-100-2
Ceiling - Ceiling	125	+ 25 /-75	[100]									125	2000-A01-125-2
4 Hour Fire Rated (240 mins)													
Floor - Floor	25	± 12	[25]					100	-	-	-	25	2000-A02-025-4
	35	± 17	[35]									35	2000-A02-035-4
Floor - Wall	50	± 25	[50]									50	2000-A02-050-4
Wall - Wall	75	± 37	[75]	-	-	-	-					75	2000-A02-075-4
Corner Wall	100	± 50	[100]									100	2000-A02-100-4
Ceiling - Ceiling	125	+ 25 /-75	[100]									125	2000-A02-125-4

## Features

### Movement

Easy to install

High movement capacity  $\pm 50$ mm

ASTM E-1399 Class I: Thermal  
Class II: Wind

### Material

Intumescent graphite layers

Class O foam

## Traffic Frequency per day



- - - - -

## System Options

Gap width(s)	25, 35, 50, 75, 100, 125 mm
Height(s)	Not applicable
Metal type(s):	None
Colour(s)	Black intumescent seal
Fire barrier	BS 476: 120-240 minutes
Waterproofing	Waterproofing membrane
Pre-assembly in factory	Contact Vexcolt

## Fireflex 2000 : A01-A02



## APPLICATIONS

Airport Terminals | Educational | Exhibition Centres  
Department Stores | Distribution & Retail Warehouses  
Factories | Hospitals | Museums | Offices & Hotels  
Parking | Places of Worship | Residential Buildings  
Rail, Metros & Elevated Rail Stations | Roads & Bridges  
Shopping Centres | Sports Stadiums | Supermarkets